

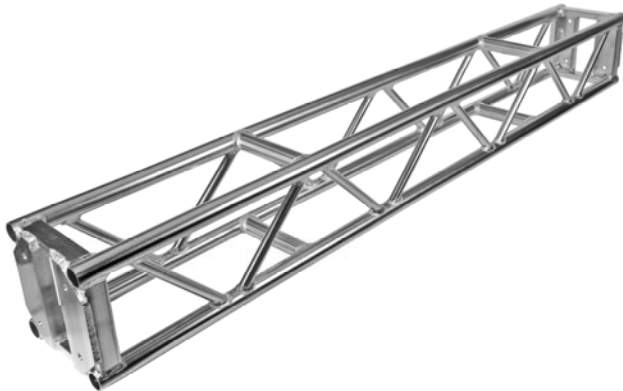

FEATURES

- Highly Polished Aluminum Tubing
- 1.9" OD 6061-T6 Aluminum Tube Schd #40
- 0.145" Wall Thickness
- 1.05" OD Aluminum Bracing
- Fabricated By Certified Welders
- Custom Lengths & Corners Available
- Available With Steel Spigots
- Powder Coating Available

Applied Electronics All Purpose truss is manufactured with schedule 40, 1.9" OD x 0.145" wall main chords and 1.05" OD x 0.125" wall diagonal bracing. All components are 6061-T6 aluminum tubing and 5/8" grade 8 bolts are included for assembly of the truss elements. All Purpose truss, combined with the matching corner blocks, can be used to construct a grid.



PLATED ALLOWABLE LOAD DATA

| SPAN (ft.) | UNIFORMLY DISTRIBUTED LOAD | | | CENTER POINT LOAD | |
|------------|----------------------------|----------|------------------|-------------------|------------------|
| | LOAD (#/ft.) | LOAD (#) | MAX. DEFL. (in.) | LOAD (#) | MAX. DEFL. (in.) |
| 10 | 604 | 6040 | 0.17 | 2940 | 0.19 |
| 20 | 212 | 4240 | 0.96 | 2122 | 0.77 |
| 30 | 84 | 2520 | 2.00 | 1364 | 1.75 |
| 40 | 28 | 1120 | 2.39 | 565 | 2.01 |

Connection: 5/8" Dia. x 2" Grade 8 Bolts

Weight Load Certified By Structural Engineer

- All Uniform & Point Loads Are Equally Distributed Between The Two Bottom Chord Members.
- Do Not Load Top Chord Of Truss Without Contacting Engineer For Approval.
- Self-Weight Of The Truss Is Accounted For In The Calculation Of All Loading Conditions Listed Above.
- For Point Load Condition, Invert The Truss As Required To Assure Point Load Is Applied Within 4" Of A Truss Node.

ORDERING INFORMATION

| Item No. | Dimensions | Weight |
|-----------|------------------|---------|
| 11-12-120 | 12" x 12" x 10' | 60 lbs. |
| 11-12-096 | 12" x 12" x 8' | 52 lbs. |
| 11-12-060 | 12" x 12" x 5' | 37 lbs. |
| 11-12-030 | 12" x 12" x 2.5' | 24 lbs. |
| 11-12-004 | 4-Way Corner | 22 lbs. |
| 11-12-005 | 5-Way Corner | 25 lbs. |
| 11-12-006 | 6-Way Corner | 29 lbs. |

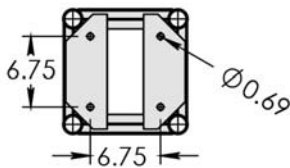

Front View

Top View



Side View

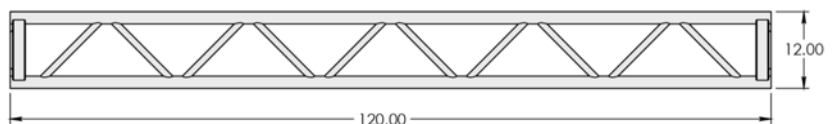

Standard Corner

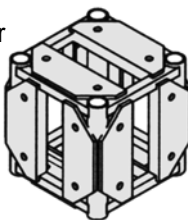

Custom Corner

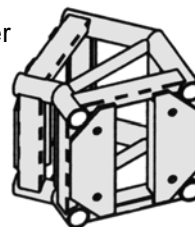

Hinge

