

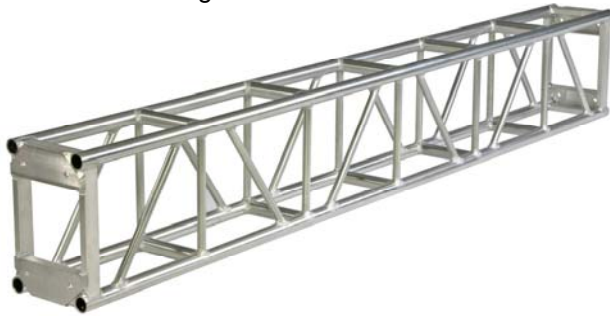

PLATED FEATURES

Highly Polished Aluminum Tubing
 1.9" OD 6061-T6 Aluminum Tube Schd #40
 0.145" Wall Thickness
 1.05" OD Aluminum Bracing
 Fabricated By Certified Welders
 Custom Lengths & Corners Available
 Powder Coating Available



Applied Electronics Heavy Duty 12" x 18" Box Truss is manufactured with schedule 40, 1.9" OD x 0.145" wall main chords and 1.05" OD x 0.125" wall diagonal bracing. All components are 6061-T6 aluminum tubing and 5/8" grade 8 bolts are included for assembly of the truss elements. It can be used to construct a grid when combined with the matching corner blocks.

PLATED ORDERING INFORMATION

Item No.	Dimensions	Weight
9-01-120	12" x 18" x 10'	67 lbs.
9-01-096	12" x 18" x 8'	58 lbs.
9-01-060	12" x 18" x 5'	45 lbs.
9-01-030	12" x 18" x 2.5'	25 lbs. est
9-01-004	4-Way Corner	20 lbs.

PLATED ESTIMATED LOAD DATA



SPAN (ft.)	LOAD (#/ft.)	LOAD (#)	MAX. DEFL. (in.)	LOAD (#)	MAX. DEFL. (in.)
10	425	4250	2.213	2400	0.212
20	155	3100	0.833	1750	0.860
30	75	2250	1.361	1350	1.432
40	45	1800	2.587	950	2.552

Connection: 5/8" Dia. x 2" Grade 8 Bolts

SPIGOTED FEATURES

Highly Polished Aluminum Tubing
 1.9" OD 6061-T6 Aluminum Tube Schd #80
 0.200" Wall Thickness
 1.05" OD Aluminum Bracing
 Steel Spigots and Pins
 Fabricated By Certified Welders
 Custom Lengths & Corners Available
 Powder Coating Available

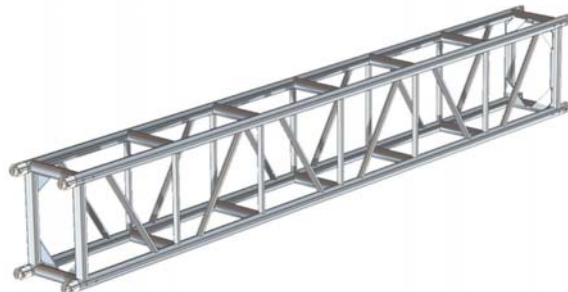

SPIGOTED ORDERING INFORMATION

Item No.	Dimensions	Weight
13-06-120	12" x 18" x 10'	75 lbs.
13-06-096	12" x 18" x 8'	65 lbs. est
13-06-060	12" x 18" x 5'	50 lbs.
13-06-030	12" x 18" x 2.5'	40 lbs. est
13-06-002	2-Way Corner	20 lbs.
13-06-004	4-Way Corner	20 lbs.
13-06-005	5-Way Corner	25 lbs.

SPIGOTED ESTIMATED LOAD DATA



SPAN (ft.)	LOAD (#/ft.)	LOAD (#)	MAX. DEFL. (in.)	LOAD (#)	MAX. DEFL. (in.)
10	690	6900	0.233	3100	0.206
20	210	4200	0.565	2100	0.540
30	138	4140	1.194	1850	1.038
40	95	3800	2.183	1600	1.808

Connection: Steel Spigots and 3/4" x 2-1/2" Clevis Pins