

ARCHITECTURAL TRUSS

Ultra Lite 8"x8" & 12"x12" Box

Lite Duty 8"x8" & 12"x12" Box



ULTRA LITE FEATURES

- Highly Polished Aluminum Tubing
- 1.05" OD 6061-T6 Aluminum Tube
- 0.113" Wall Thickness
- 3/8" Solid Aluminum Rod Bracing
- 1-3/4" x 1/4" Aluminum End Plates
- Fabricated by Certified Welders
- Custom Lengths & Corners Available
- Powder Coating Available

Ultra Lite Box truss is manufactured with 1.05" OD main chords and 3/8" solid aluminum rod bracing. Lite Duty Box truss is manufactured with 1-3/8" OD main chords and 1/2" solid aluminum rod bracing. 3/8" grade 5 bolts are included for assembly of the truss elements. They are ideal for trade show booths, small venues, retail showrooms and other installations with light load limits. The highly polished aluminum finish blends with contemporary design elements or this truss can be powder coated to match any interior design scheme. The Lite Duty Box truss is ideal for circles, stars and other unique projects.

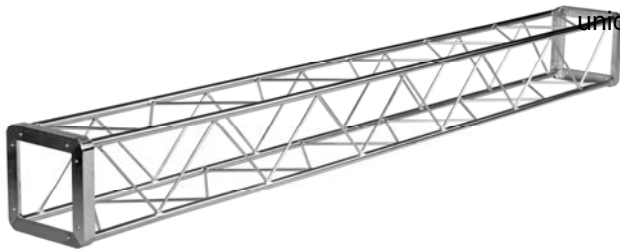

ORDERING INFORMATION

Item No.	Dimensions	Weight
6-08-120	8" x 8" x 10'	25 lbs.
6-08-096	8" x 8" x 8'	18 lbs.
6-08-060	8" x 8" x 5'	13 lbs.
6-08-030	8" x 8" x 2.5'	9 lbs.
6-08-006	6-Way Corner	8 lbs.
6-12-120	12" x 12" x 10'	30 lbs.
6-12-096	12" x 12" x 8'	22 lbs.
6-12-060	12" x 12" x 5'	17 lbs.
6-12-030	12" x 12" x 2.5'	12 lbs.
6-12-006	6-Way Corner	13 lbs.

LITE DUTY FEATURES

- Highly Polished Aluminum Tubing
- 1-3/8" OD 6061-T6 Aluminum Tube
- 0.125" Wall Thickness
- 1/2" Solid Aluminum Rod Bracing
- 1-3/4" x 1/4" Aluminum End Plates
- Fabricated by Certified Welders
- Custom Lengths & Corners Available
- Powder Coating Available

ORDERING INFORMATION

Item No.	Dimensions	Weight
7-08-120	8" x 8" x 10'	37 lbs.
7-08-096	8" x 8" x 8'	25 lbs.
7-08-060	8" x 8" x 5'	18 lbs.
7-08-030	8" x 8" x 2.5'	13 lbs.
7-08-006	6-Way Corner	9 lbs.
7-12-120	12" x 12" x 10'	43 lbs.
7-12-096	12" x 12" x 8'	36 lbs.
7-12-060	12" x 12" x 5'	25 lbs.
7-12-030	12" x 12" x 2.5'	13 lbs.
7-12-006	6-Way Corner	14 lbs.

ESTIMATED LOAD DATA



SPAN (ft.)	LOAD (#/ft.)	LOAD (#)	MAX. DEFL. (in.)	LOAD (#)	MAX. DEFL. (in.)
8" x 8" Ultra Lite Box Truss Weight Loading Info					
10	90	900		600	
20	39	780		390	
30	14	420		180	
40	6	240		120	
12" x 12" Ultra Lite Box Truss Weight Loading Info					
10	150	1500		1200	
20	73	1470		900	
30	22	660		390	
40	9.75	390		240	
8" x 8" Lite Duty Box Truss Weight Loading Info					
10	119	1190	0.13	1192	0.26
20	59	1180	1.31	750	1.36
30	16	480	1.42	252	1.49
40	5	200	1.40	106	0.75
12" x 12" Lite Duty Box Truss Weight Loading Info					
10	261	2610	0.187	2000	0.25
20	122	2440	1.31	1500	1.37
30	37	1110	2.00	650	2.00
40	16	640	2.67	400	2.68

Connection: 3/8" Dia. x 1-1/4" Grade 5 Bolts

8" x 8" LD and 12" x 12" LD Weight Load Certified By Structural Engineer

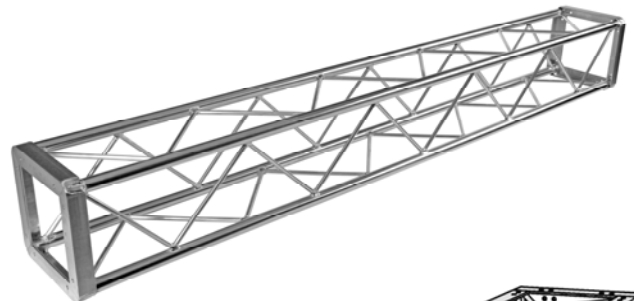

Standard Corner

